

LANE TECH SHEET

EZ Lift Pin Installation Tool

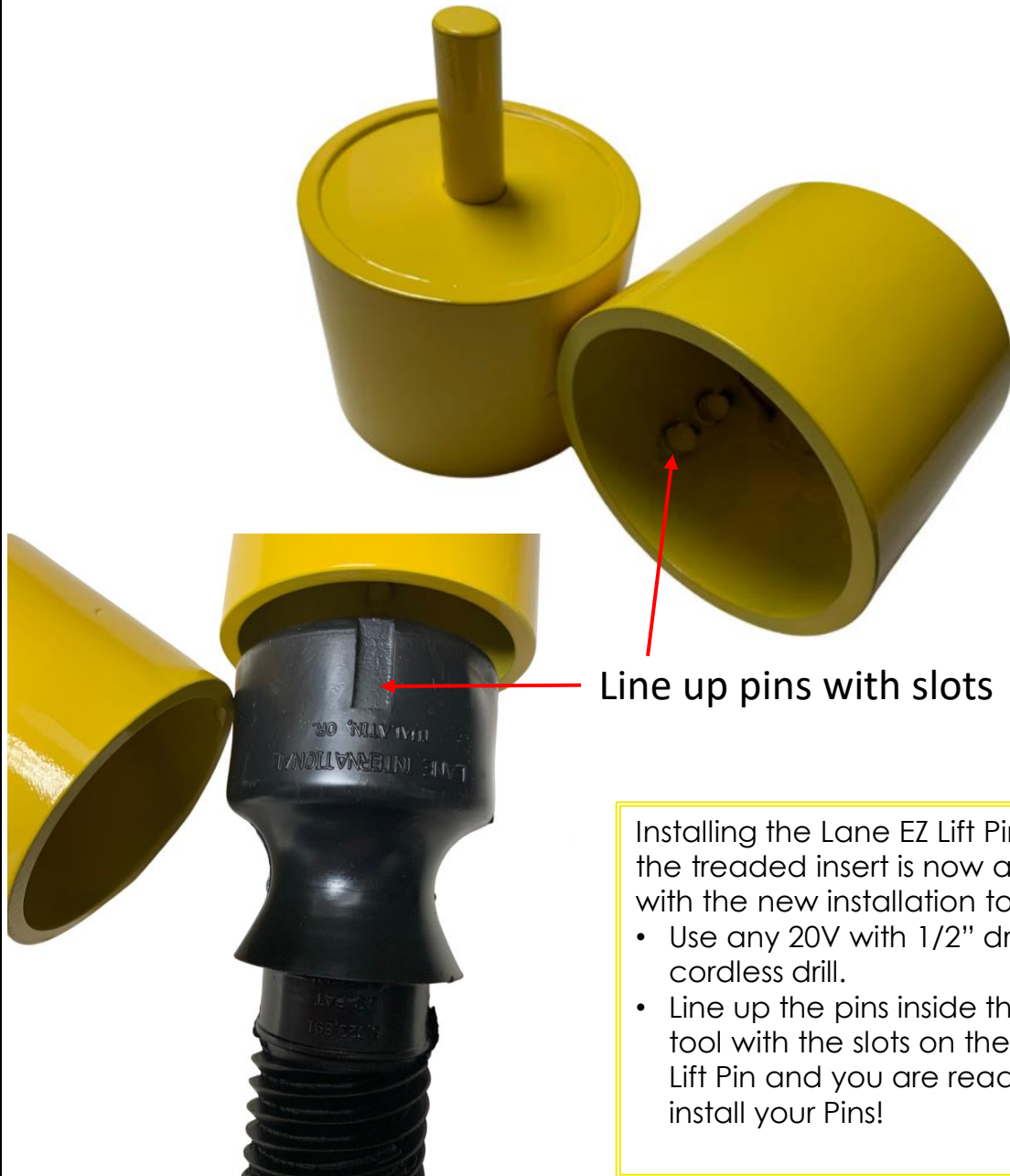

Installing the Lane EZ Lift Pin into the treaded insert is now a snap with the new installation tool.

- Use any 20V with 1/2" drive cordless drill.
- Line up the pins inside the tool with the slots on the EZ Lift Pin and you are ready to install your Pins!

Drawing: 1
Scale: None

EZ Lift Pin
Installation Tool
Part # DR-4000

LANE INTERNATIONAL
CORPORATION

P.O. Box 925 * Tualatin, OR 98062
503-692-9860 * www.laneinternational.com